



ACCESSORI



FITTINGS



ACCESSOIRES



ZUBEHÖRTEILE



ACCESORIOS

**Valvola compensatrice di pressione con raccordo Femmina DIN
in acciaio inox DN 50**

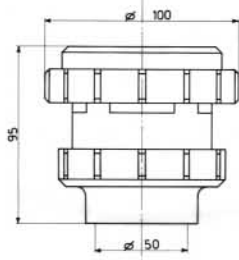

PRESSIONE: + 0,002 Kp/cm²
DEPRESSIONE: - 0,002 Kp/cm²

Pressure compensating valve with threaded DIN female coupling in DN 50 stainless steel.
PRESSURE: + 0,02 Kp/cm²
DEPRESSION: - 0,02 Kp/cm²

Druckausgleichventil NW 50 (Be- u. Entlüftung) federbelastet, zum Aufschrauben. Druckbereich von - 0,02 bis + 0,02 Kp/cm².

Soupape compensation pression / depression avec nez fileté à souder DIN en inox DN 50
PRESSION: +0,02 Kp/cm²
DEPRESSION: -0,02 Kp/cm²

Válvula de compensación de presión con macho DIN de acero inox dable DN 50
PRESION: +0,02 Kp/cm²
DEPRESSION: -0,02 Kp/cm²

Valvola compensatrice pressione/depressione in polietilene Ø 2"

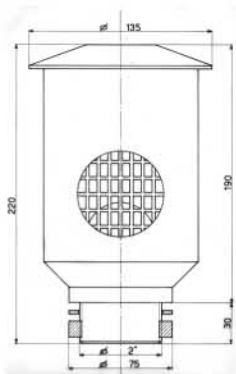

2" dia. pressure/depression compensating valve in polyethylene

Polyäthylen Druckausgleichventil. Ø 2"

Soupape compensation pression/dépression en polythylene Ø 2"

Válvula de compensación de presión/depresión de polietileno diám. 2".

Valvola compensatrice pressione/depressione in polietilene Ø 1"1/4.

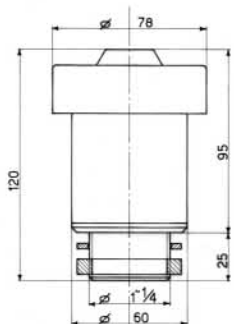

1"1/4 dia. pressure/depression compensating valve in polyethylene

Polyäthylen Druckausgleichventil. Ø 1"1/4

Soupape compensation pression/dépression en polythylene Ø 1"1/4

Válvula de compensación de presión/depresión de polietileno diám. 1" 1/4.

Art. E 25



Art. E 26



Art. E 27



Art. E 28



Valvola compensatrice pressione/depressione in polietilene Ø 1"1/4.

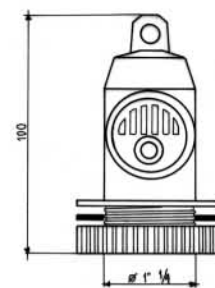

1"1/4 dia. pressure/depression compensating valve in polyethylene

Polyäthylen Druckausgleichventil. Ø 1"1/4

Soupape compensation pression/dépression en polythylène Ø 1"1/4

Válvula de compensación de presión/depresión de polietileno diám. 1" 1/4.

Art. E 29



Valvola di sfiato di gomma

Rubber vent.

Entlüftungsvent aus Gummi.

Soupape en caoutchouc.

Válvula de escape de goma.

Art. E 32



Sfiato libero curvo in polietilene ø 2"

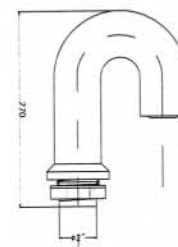

2" Diameter curved vent pipe in polyethylene

Freier gebogener Entlüfter aus Polyäthylen ø 2"

Event coudé aus polyéthylène ø 2"

Escape libre curvo de polietileno diám 2"

Chiave inox stampata con sede quadra per art. C1-C2-C3

Pressed stainless steel spanner for art. C1-C2-C3

Art. CHVQDRZ101



Chiave inox stampata con sede quadra per art. C4-C5

Pressed stainless steel spanner for art. C4-C5

Art. CHVQDRZ102



Galletto in bronzo cromato M12 per art. B18-B20-D12

Bronze plated wing nut M12 for art. B18-B20-D12

Art. GLLBRZT201



Volantino in nilon diam. 70 con bronzina M12 nero lobato per art. D5 - D7 - D8 - D9 - D10 - D11 - D14 - D17 - D18 D20 - D22

Nylon hand-wheel diam. 70 with brass bearing M12 black for art. D5-D7-D8-D9-D10-D11-D14-D17-D18-D20-D22

Art. VLT1207004



Art. **VLT1209001S**



Volantino inox diam. 90 con bronzina M12 satinato per art. D 15-D19

*Stainless steel hand-wheel diam. 90 with
brass bearing M12 for art.
D15-D19*

Art. **VLT1210001**



Volantino in bronzo cromato diam. 100 M12

Bronze plated hand-wheel diam. 100 M12

Art. **VLT12RZ101L**



Volantino inox a 1 razza con boccia M12 lucido per art. D4

*Handle with one stainless steel spoke
M12 for art. D4*

Art. **VLT1609004**



Volantino in nylon diam. 90 con bronzina M16 nero per art. D2-D3-D26

*Nylon hand-wheel diam. 70 with brass
bearing M16 black for art. D2-D3-26*

Volantino inox diam. 90 con boccia M16 satinato per art. D2-D3-D13

Stainless steel hand-wheel diam. 90 M16 for art D2-D3-D13

Art. VLT1609002S



Volantino in bronzo cromato diam. 100 M16

Bronze plated hand-wheel diam. 100 M16

Art. VLT1610001



Volantino in termoind. diam. 90 con bronzina M18x1,5 nero per art. A9-A10-A14-B16-D4

Hand-wheel made of thermosetting material diam. 90 with brass bearing M18x1,5 for art. A9-A10-A14-B16-D4

Art. VLT1809001



Volantino inox diam. 90 con boccia M18x1,5 lucido art. A19-A23

Stainless steel hand-wheel diam. 90 with brass bearing M18x1,5 for art. A19-A23

Art. VLT1809002L



Art. **VLT1810001L**



Volantino inox diam. 100 con bronzina M18x1,5 lucido

*Stainless steel hand-wheel diam. 100
with brass bearing M18 x1,5*

Art. **VLT1810003**



Volantino in bronzo cromato diam. 100 M18x1,5

Bronze plated hand-wheel diam. 100 M18x1,5

Art. **VLT1816001**



**Volantino in nylon diam. 160 con bronzina M18x1,5 nero per
art. A3 - A5 - A6 - A7 - A8 - A13 - B1 - B2**

*Nylon hand-wheel diam. 160 with brass bearing
M18x1,5 black for
art. A3 - A5 - A6 - A7 - A8 - A13 - B1 - B2*

Art. **VLT18RZ202L**



**Volantino inox a 2 razze con bronzina M18x1,5 lucido MOD.
ECONOMICO**

*Stainless steel hand-wheel with two
spokes, brass bearing M18x1,5 economic
version*

Volantino inox a 2 razze con bronzina M18 lucido per art. D1

*Stainless steel hand-wheel with two spokes,
brass bearing M18 for art. D1*

Art. VLT18RZ205L



**Volantino inox a 2 razze con bronzine M22 lucido per
art. A1 - A2 - A4 - A17 - A18**

*Stainless steel hand-wheel with two spokes,
brass bearing M22 for
art. A1 - A2 - A4 - A17 - A18*

Art. VLT22RZ201L



**Volantino inox a 2 razze con bronzina M22 satinato per art.
A15 - A16 - A26**

*Stainless steel hand-wheel with two spokes,
brass bearing M22 for art. A15 - A16 - A26*

Art. VLT22RZ201S



**Volantino inox a 2 razze con bronzina M27 lucida per art.
A11 - A12**

*Stainless steel hand-wheel with two
horizontal spokes, brass bearing M27
for art. A11 - A12*

Art. VLT27RZ201L

